

DEED PLAN. AT D. TALLYGUNGE-SADAR. MOUZA-BAISHNAB-GHATA.
 J.L. NO 28, TOUZI NO 564151, KHATIAN NO 308, DUG NO 252253.
 R.S. NO 11. SCALE 20'-0" = 1" INCH.

AREA OF LAND - K-CH-SFT
 4-0-0
 OWNER - LATIKA CHATTERJEE

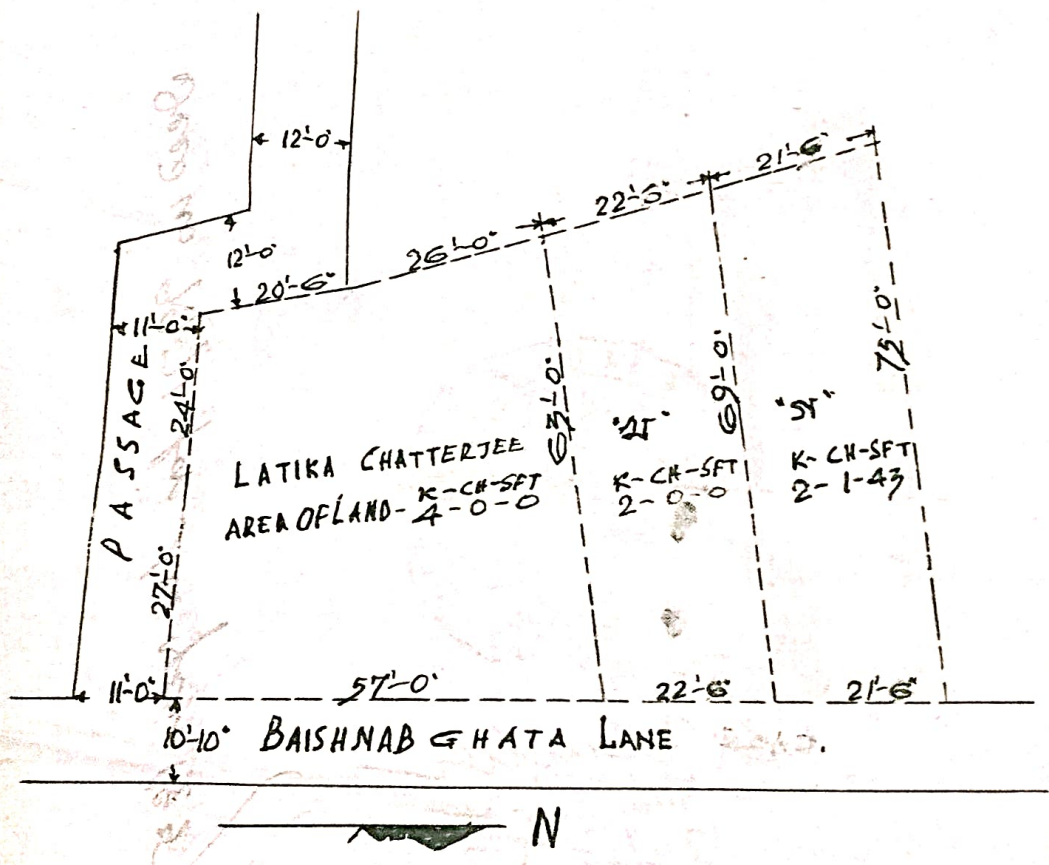

Informing Government is the duty of the owner.

DRAWN BY -
 LAKSHI NARAYAN ENGINEERING WORK
 35/A, GIRISH MUKHERJEE ROAD.
 BRAHMANI DUR - CAL-25, DT 13-3-57.

THE STATE OF CALIFORNIA
COUNTY OF LOS ANGELES

OFFICE OF THE COUNTY CLERK
COURT HOUSE, LOS ANGELES, CALIF.

Dec 20 1857



[Handwritten signature]

24/12/57

THE STATE OF CALIFORNIA
COUNTY OF LOS ANGELES